

HANGING WIRES

TWISTER™

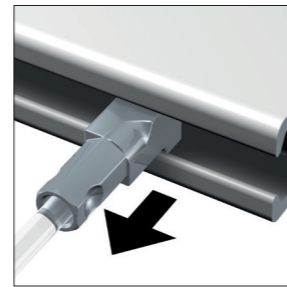
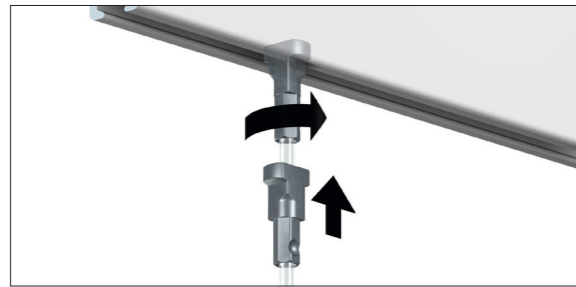
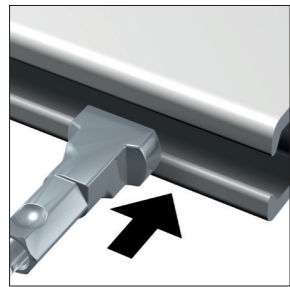

MAX.
20 KG

1 SIMPLE-SAFE-STRONG

Artiteq developed the Twister glider system for all its hanging rails. Twister offers the most Logical and user-friendly way to hook the hanging wire into the rail: insert, twist, click and you're done. Since the Twister may be clicked anywhere on the rail, you can hang a picture anywhere you like on the wall. You have the option of using Twister in perlon, steel wire or rods for all the Artiteq hanging systems. The perlon and steel hanging wires with the Twister mechanism are available in 1 or 2 mm thicknesses, and in lengths ranging from 100 to 500 cm.

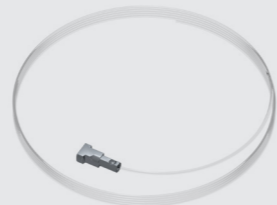

1 mm

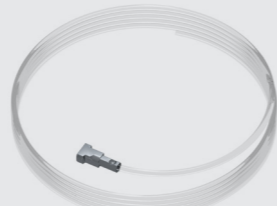

2 mm

TWISTER™

Twister is a European Registered Community Design.

TWISTER™ CLIQ2FIX perlon

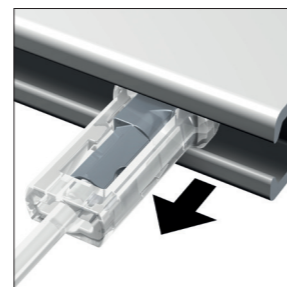
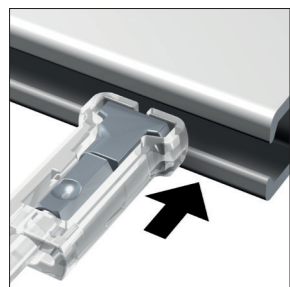

MAX.
20 KG

2 EXTRA EASE-OF-USE

Thanks to the development of the Twister Cliq2Fix perlon system, perlon cord now has an additional functionality when it comes to hanging pictures. The hanging wire equipped with the Twister Cliq2Fix system may be inserted in the rail, eliminating the risk of the perlon cord popping loose from the rail as a result of its recoiling effect. This makes it extra safe, and easy to slide into the rail. In other words, extra ease-of-use.



2 mm

HANGING WIRES

SOLID SLIDER

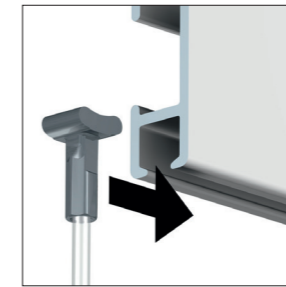
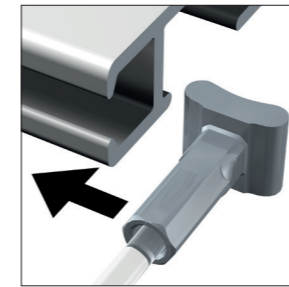

SLIDER ECONOMY
not visible in the rail

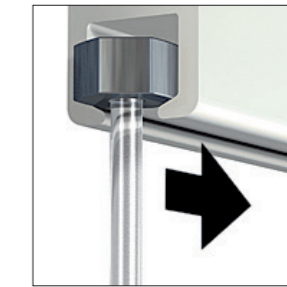
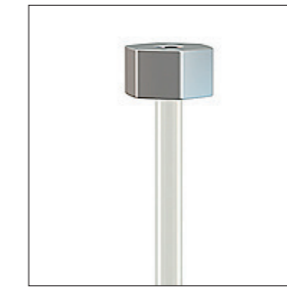

MAX.
20 KG

MAX.
15 KG

3 SLIDE INTO SIDE

Artiteq developed the Solid Slider system which attaches the hanging wire with glider via the side of the rail. This system is available for 2 mm perlon and 2 mm steel wire. The hanging wire may be freely slid into the hanging rail, yet may not be removed from the rail as easily. Hanging wires with the Solid Slider mechanism are available in lengths of 100, 150, 200, 250, 300 en 500 cm. A slanted stop system is available for slanted walls. This system makes it possible to use a flexible picture hanging system even with slanted walls, for example in a staircase.

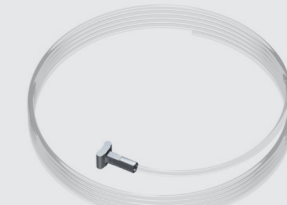

2 mm

1 mm					
TWISTER 1 mm					
	30.21150	TWISTER	1 mm	PERLON	150 cm
	30.21200	TWISTER	1 mm	PERLON	200 cm
	30.21300	TWISTER	1 mm	PERLON	300 cm
	30.22150	TWISTER	1 mm	STEEL	150 cm
	30.22200	TWISTER	1 mm	STEEL	200 cm
	30.22300	TWISTER	1 mm	STEEL	300 cm
	09.63150	TWISTER	1 mm	STEEL BLACK	150 cm
	09.63200	TWISTER	1 mm	STEEL BLACK	200 cm
	09.63300	TWISTER	1 mm	STEEL BLACK	300 cm

2 mm					
TWISTER 2 mm					
	09.23100	TWISTER	2 mm	PERLON	100 cm
	09.23150	TWISTER	2 mm	PERLON	150 cm
	09.23200	TWISTER	2 mm	PERLON	200 cm
	09.23250	TWISTER	2 mm	PERLON	250 cm
	09.23300	TWISTER	2 mm	PERLON	300 cm
	09.23500	TWISTER	2 mm	PERLON	500 cm
	09.33100	TWISTER	2 mm	STEEL	100 cm
	09.33150	TWISTER	2 mm	STEEL	150 cm
	09.33200	TWISTER	2 mm	STEEL	200 cm
	09.33250	TWISTER	2 mm	STEEL	250 cm
	09.33300	TWISTER	2 mm	STEEL	300 cm
	09.33500	TWISTER	2 mm	STEEL	500 cm
	9.4196	TWISTER	2 mm	ROD WHITE	100 cm
	9.4198	TWISTER	2 mm	ROD WHITE	200 cm

2 mm					
TWISTER CLIQ2FIX PERLON					
	09.13100	TWISTER CLIQ2FIX	2 mm	PERLON	100 cm
	09.13150	TWISTER CLIQ2FIX	2 mm	PERLON	150 cm
	09.13200	TWISTER CLIQ2FIX	2 mm	PERLON	200 cm
	09.13250	TWISTER CLIQ2FIX	2 mm	PERLON	250 cm
	09.13300	TWISTER CLIQ2FIX	2 mm	PERLON	300 cm

2 mm					
SOLID SLIDER					
	08.23100	SOLID SLIDER	2 mm	PERLON	100 cm
	08.23150	SOLID SLIDER	2 mm	PERLON	150 cm
	08.23200	SOLID SLIDER	2 mm	PERLON	200 cm
	08.23250	SOLID SLIDER	2 mm	PERLON	250 cm
	08.23300	SOLID SLIDER	2 mm	PERLON	300 cm
	08.23500	SOLID SLIDER	2 mm	PERLON	500 cm
	08.43100	SOLID SLIDER	2 mm	STEEL	100 cm
	08.43150	SOLID SLIDER	2 mm	STEEL	150 cm
	08.43200	SOLID SLIDER	2 mm	STEEL	200 cm
	08.43250	SOLID SLIDER	2 mm	STEEL	250 cm
	08.43300	SOLID SLIDER	2 mm	STEEL	300 cm
	08.43500	SOLID SLIDER	2 mm	STEEL	500 cm